

# Nanoleaf Skylight

## User Manual



## Welcome to Smarter Living

Congratulations on becoming an official owner of Nanoleaf Skylight. Here's a guide with everything you'll need to get started, tips for more advanced features, steps for troubleshooting, and more.

STEP 1	STEP 2	STEP 3
<b>Physical Setup</b>  Refer to the detailed instructions <a href="#">here</a> or the ones outlined in the printed Quick Start Guide.	<b>Download Nanoleaf App</b>  Download the Nanoleaf App on the <a href="#">Apple App Store</a> or on <a href="#">Google Play</a> .	<b>Pair &amp; Setup with Nanoleaf App</b>  Pair, setup and calibrate your Nanoleaf Skylight with the App to access customization features.

# Table of Contents

- Product Setup ..... 5**
  - What’s in the box? ..... 5
  - Physically setting up your Nanoleaf Skylight ..... 6
  - Pairing & Setting Up Your Skylight for iOS ..... 15
  - Pairing & Setting Up Your Skylight for Android ..... 16
  - Controlling Your Nanoleaf Skylight Device ..... 17
- Problems and Solutions ..... 19**
  - Reset Options ..... 19
  - Common Solutions ..... 20
  - FAQs ..... 21



# Product Setup

## What's in the box?



### **Nanoleaf Skylight Smarter Kit (3 Pack)**

**1x** Main Controller Panel

**2x** Expansion Panels

**1x** Mounting Plate

Power Wires

Communication Linkers

Screws

## Physically setting up your Nanoleaf Skylight



### CAUTION!

This installation **requires** basic electrical experience.

If you lack experience in this type of installation, please consult or enlist the services of a qualified professional.

Before you start, plan your design by aligning and marking the panels of your desired layout on the ceiling. As this is **a hardwired product that requires to be screwed into your ceiling**, we strongly recommend purchasing any expansion panels you may need and installing them all at once with your main controller panel.

## Step One: Mount the Main Controller Panel

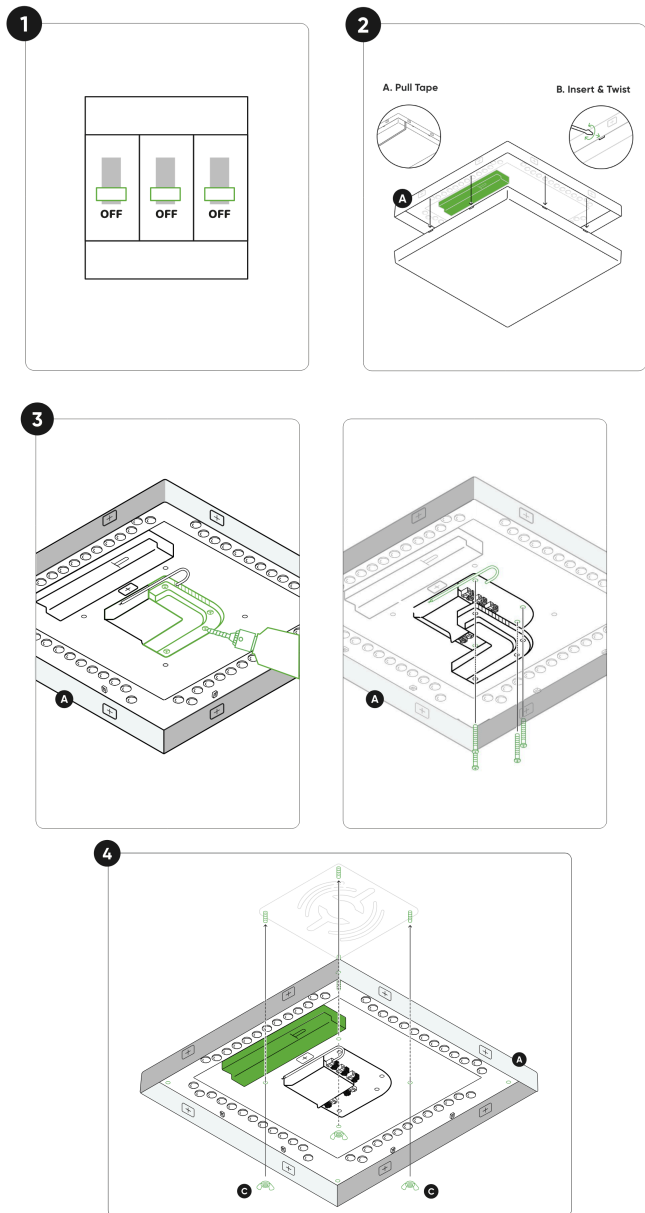

1. Turn the circuit power and the light switch off before you start.
2. To open the **Main Controller Panel (A)**:
  - a. Pull the clear tape on the panel.
  - b. Insert a flat head screwdriver into one of the small notches along the seam. Slightly twist the screwdriver
3. Remove the **L Shape Cover** to reveal the terminal block for wiring.
4. Remove the **Ceiling Plate** by unscrewing the **Wing Nuts (C)**

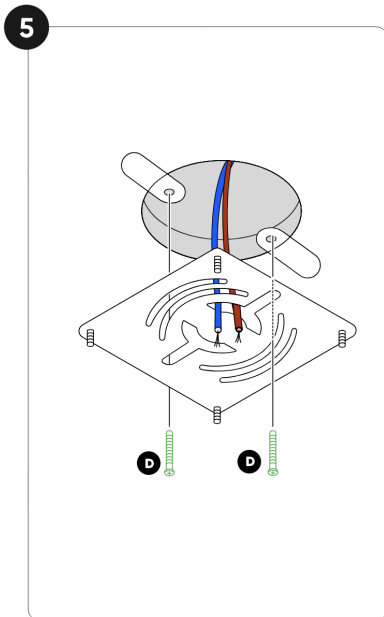

5. If mounting with the **Ceiling Plate**, ensure that the wires are positioned through the hole of the plate with a suitable length visible.
  - a. Fasten the **Ceiling Plate** so that it is parallel to your desired panel alignment.

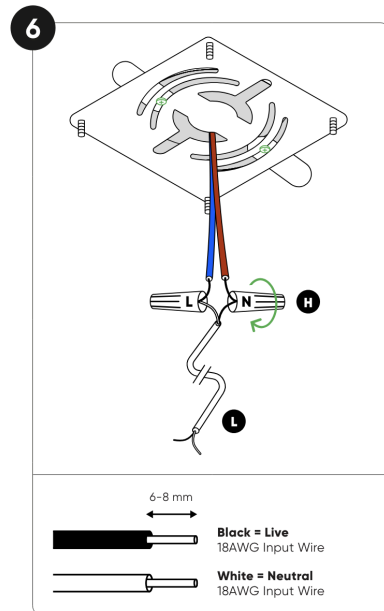

6. The Main Controller **Power Wires (L)** attached to the **Main Controller Panel (A)** can be connected with junction box wires using the included **Binding Posts (H)**.

A. Black = Live

B. White = Neutral

- a. Make sure the wires are secure and connected to the corresponding wires.

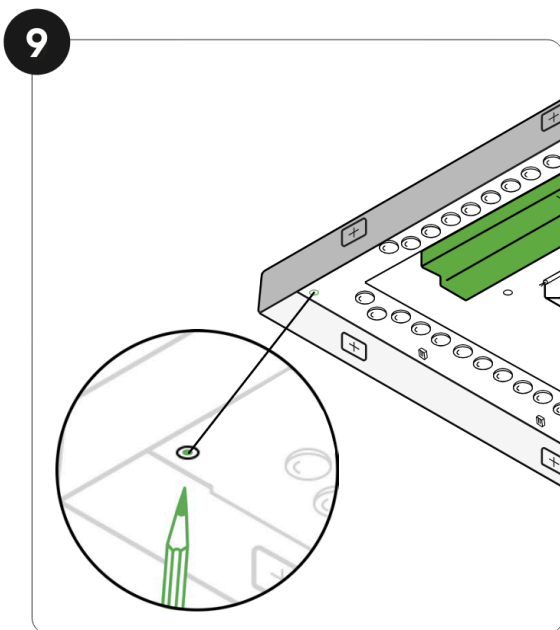
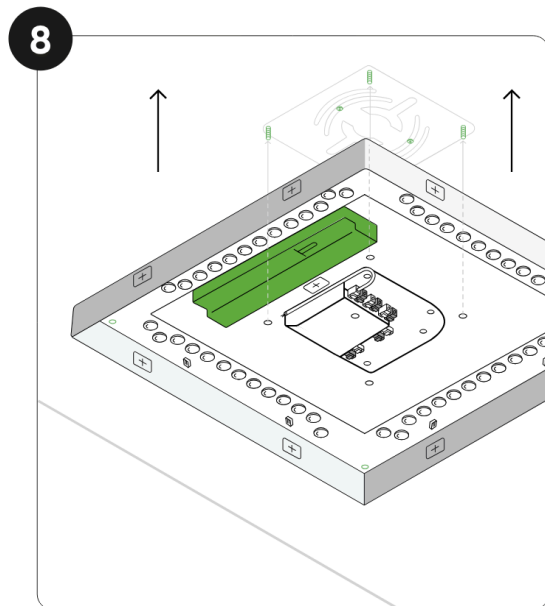
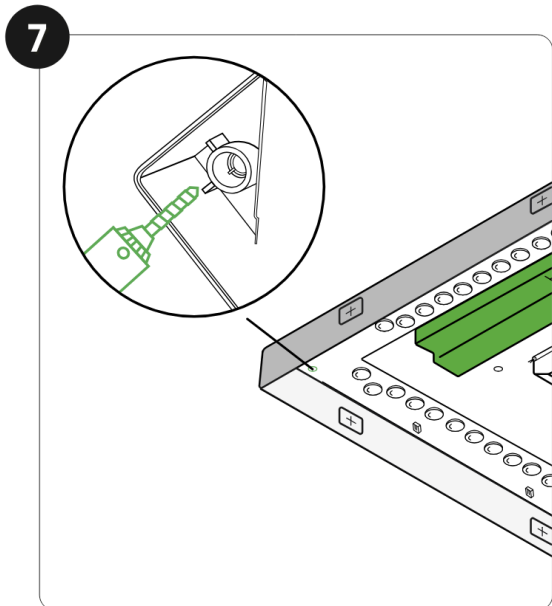

7. Use the electric drill ( $\varnothing 6\text{mm}$ ) to break through the four knockout holes.
8. Positioning the **Main Controller Panel (A)** at the desired ceiling location and holding it against the ceiling.
9. Take a pencil and mark each screw hole on the ceiling.

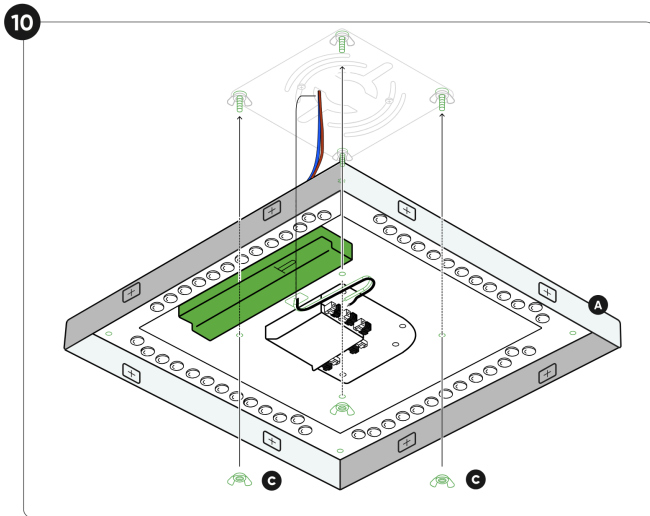

10. Now align and mount the **Main Controller Panel (A)** back to the **Ceiling Plate**.

- a. Make sure the wires have passed through the Ceiling Plate and that the **Main Controller Panel (A)** sits secure and flat on the plate.
- b. Secure the Ceiling Plate with the **Wing Nuts (C)**.

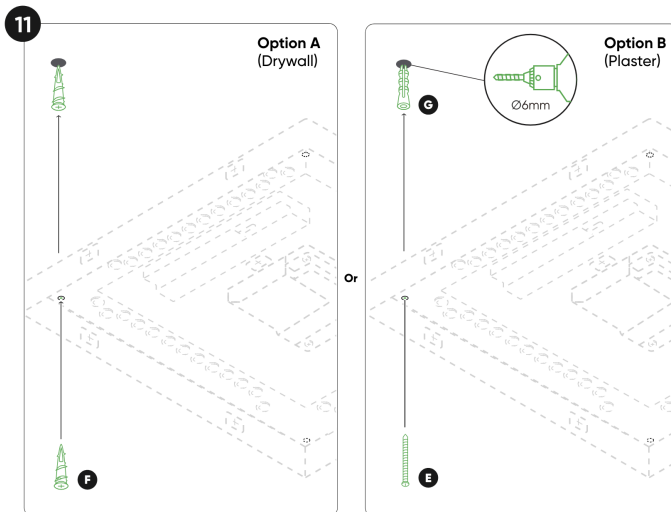

11. Using the provided anchors and screws, mount your **Main Controller Panel (A)** in place with the four knockout holes in the corner of each panel. To mount the panel in place you can use:

- a. **Drywall Anchors (F):**  
Screw in the four **Drywall Anchors (F)** to the four spots you marked prior,

**OR**

- b. **Plaster Anchors (G) :**  
Drill a hole of 6mm (OD) then drive the **Mounting Screw (E)** into the **Plaster Anchor (G)**.



## Step Two: Connect Electrical Wiring

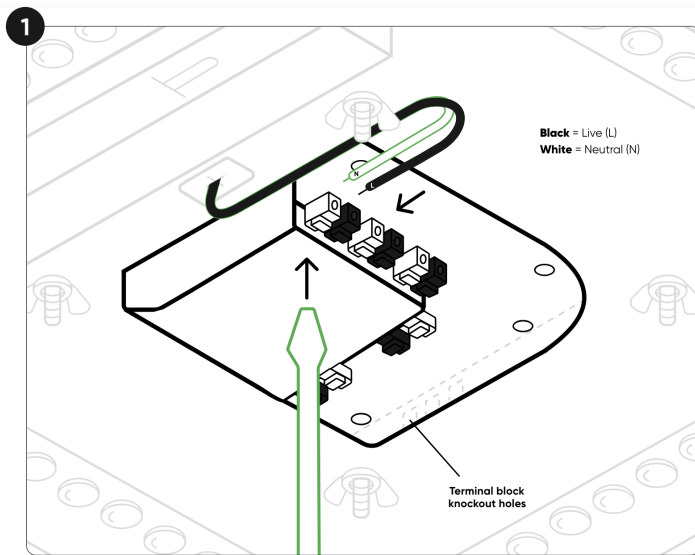

1. Insert the ceiling wires into any of the slots on the terminal block. Use your finger or a screwdriver to push the clamps when inserting. Make sure the wires are secured in place such that it cannot be pulled out.
  - a. **Black** = Live (L)
  - b. **White** = Neutral (N)
2. Remove any terminal block knockout holes as needed.

## Step Three: Mount Expansion Panels

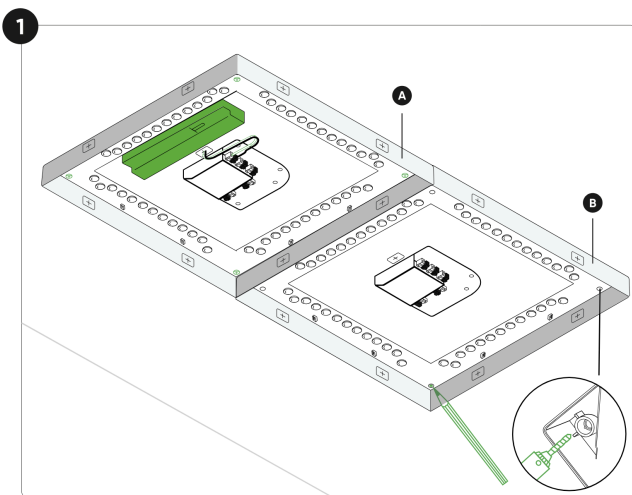

1. Add an **Expansion Panel (B)** and position it next to the **Main Controller Panel (A)**.
2. Remove the knockout holes on all four corners, hold it against the ceiling and mark each screw holes with a pencil.
3. For each **Expansion Panel (B)**, repeat the steps for mounting found on **Page 7**.
  - a. **Drywall Anchors (F)**: Screw in the four Drywall Anchors (F) to the four spots you previously marked, OR
  - b. **Plaster Anchors (G)**: Drill a hole of 6mm (OD) then drive the Mounting Screw into the Plaster Anchor.

## Step Four: Connect the Wires

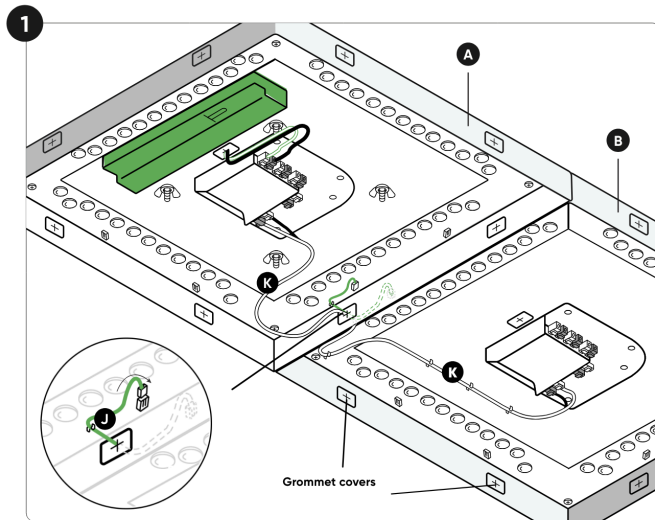

1. Thread the wires through the Grommet Cover to connect the **Communication Linker (J)** from the **Main Controller Panel (A)** to the **Expansion Panel (B)** through the linker slot.
2. Attach the **Power Wires (K)** to the socket closest to the next expansion panel. Follow the embossed line and wire through the opening to the next panel where the Communication Linker is attached.
3. Repeat this step for additional panels you add.

## Step Five: Power On

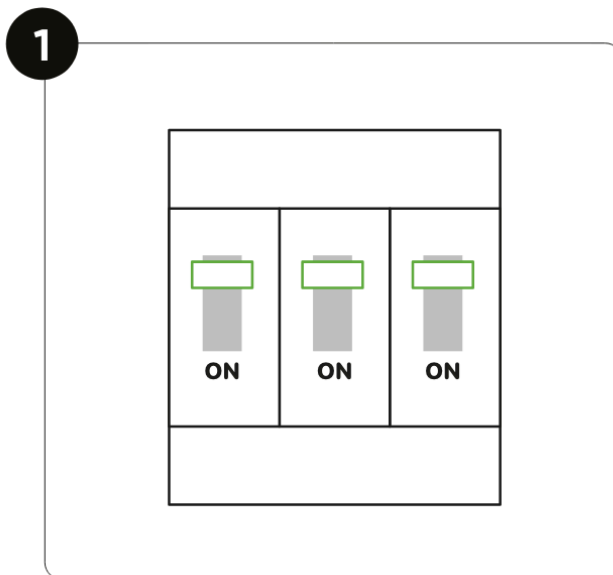

1. Turn the circuit power back on and turn the light switch on to power the panels

2

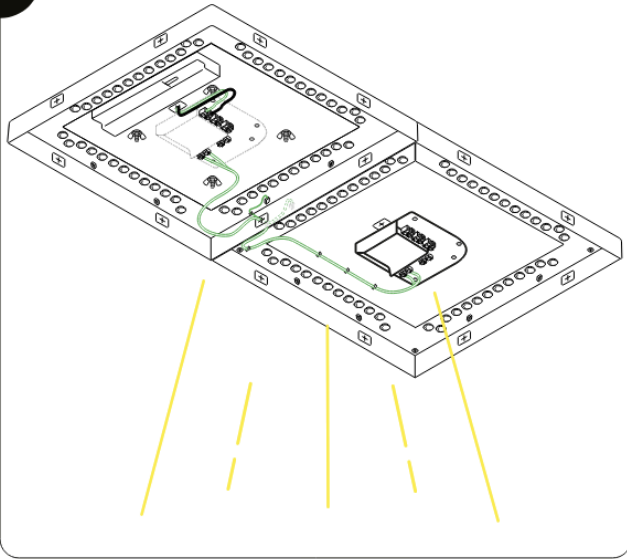

2. Your new Skylight panels will now power on at low brightness. Once the boot-up process is complete, the panels will gradually shift to full brightness to indicate that the system is ready for pairing.
3. Reinstall the L Shape Cover.

3

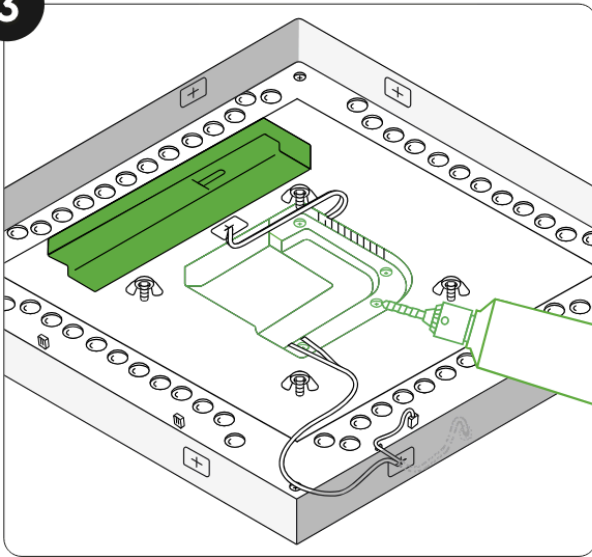

## Step Six: Pair with the App

1. Download Nanoleaf App on iOS/Android.
  - a. Pair the device by scanning the printed pairing code on the Main Controller Panel or the printed QR code on the Quick Start Guide.
  - b. Follow the in-app instructions to complete pairing. See Pairing Section for more details.

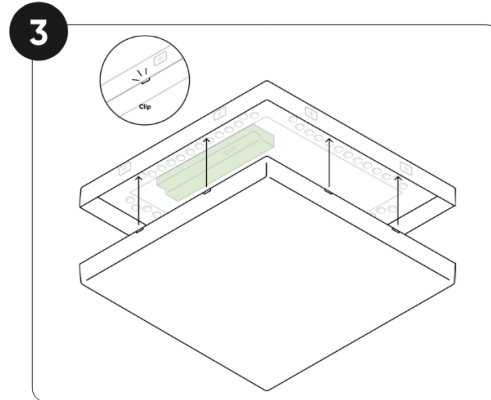
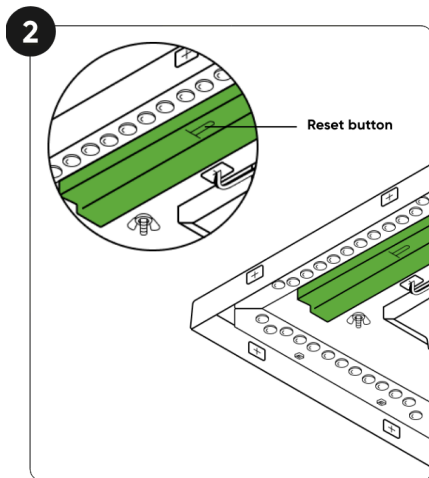

2. Press the reset button on the Main Controller Panel if app fails to find the device
3. Once Skylight is paired to the app, you can now snap all the covers back on the panels. The clips should snap securely on all sides.
4. You've successfully completed the installation. Enjoy the possibilities and control of your new Nanoleaf Skylight panels!

# Pairing & Setting Up Your Skylight for iOS

To ensure a smooth pairing process, please make sure you have the following things ready.

YOUR DEVICE	PAIRING CODE	2.4 GHZ WI-FI
Requires iOS 12+	A QR code and/or 8 digit code on your Quick Start Guide or on the Main Controller Panel	5 GHz networks are not compatible with Nanoleaf products.

## 1. Download and Open the Nanoleaf App

You can find the official Nanoleaf App in the [App Store](#). Make sure you have the latest version.

## 2. Pairing Your Skylight

- 2.1** On the Dashboard, tap the pencil icon in the top right corner.
- 2.2** Tap “Add Device +”
- 2.3** The app will automatically open up the pairing window.
- 2.4** Follow the instructions on the screen to either:
  - Scan the QR code
  - Enter the 8-digit pairing code found on the Main Controller Panel or Quick Start Guide/Welcome Card.
- 2.5** Your Nanoleaf Skylight should now be connected and ready for App setup.

# Pairing & Setting Up Your Skylight for Android

To ensure a smooth pairing process, please make sure you have the following things ready.

YOUR DEVICE	PAIRING CODE	2.4 GHZ WI-FI
Requires Android 9.0+	A QR code and/or a 8 digit code on your Quick Start Guide or on the Main Controller Panel.	5 GHz networks are not compatible with Nanoleaf products.

## 1. Download and Open the Nanoleaf App

You can find the official Nanoleaf App in the [Play Store](#). Make sure you have the latest version.

## 2. Pairing Your Skylight

**2.1** On the Dashboard, tap the pencil icon in the top right corner.

**2.2** Tap “Add Device +”.

**2.3** Scan the QR code or manually enter the 8 digit pairing code to start the pairing process

- The pairing code can be found on the Main Controller Panel or on the Quick Start Guide/Welcome Card.





**2.4** Follow the instructions on the screen to complete pairing

**2.5** Your Skylight should now be connected and ready for App setup.

# Controlling Your Nanoleaf Skylight Device

## Nanoleaf App

Turn your lighting on/off, control brightness, group lights by room, create and use Scenes, and much more.

	<b>Dashboard</b> Control your rooms and devices. Choose a premade color palette or create your own.
	<b>Discover</b> Find and download new Scenes created by the Nanoleaf community.
	<b>Resources</b> Find helpful information including tutorials, app features, integrations, and learn about other Nanoleaf products, etc.
	<b>Schedules</b> Automate your lights to turn on or off.

## Nanoleaf Desktop App

With the Nanoleaf Desktop App, you can control your Skylight from a web browser on your computer. Create and download new Scenes right from your computer, and try the Screen Mirror feature. The Desktop App was designed to simplify the management of larger installations and offer control of many different layouts at once.

[DOWNLOAD DESKTOP APP](#)

## Smart Home Ecosystems

Nanoleaf Skylight works with Apple Home, Google Home, Amazon Alexa and Samsung SmartThings. To set up with a smart home ecosystem, users must have a Nanoleaf cloud account.

## Voice Control

You can control the **Nanoleaf Skylight** by voice in a few different ways. In the Nanoleaf App, make sure to name your device something simple. Connect your device to a smart home ecosystem and a voice assistant to utilize voice control.

### Hey Siri...

“Turn [Device Name] on/off.”

“Set [Device Name] to 10% brightness.”

“Brighten/dim the lights.”

“Brighten/dim the lights to [%].”

“Set [Scene Name].”

“Set [Device Name] to [Scene Name]”

“Set [Device Name] to [Colour].”

### Okay Google...

“Turn on [Device Name or Scene Name].”

“Turn on/off the lights in [Room Name].”

“Turn on/off all my lights.”

“Turn off [Device Name].”

“Brighten/dim [Device Name].”

“Brighten/dim the lights in [Room Name].”

“Brighten/dim all my lights.”

“Set [Device Name] to [%].”

“Set [Device Name] to [Colour].”

## Nanoleaf Open API

A local network API designed to extend your product experience. Integrate your setup with third party devices and services and enable more granular control of the hardware.

**SIGN IN**



# Problems and Solutions

## Reset Options

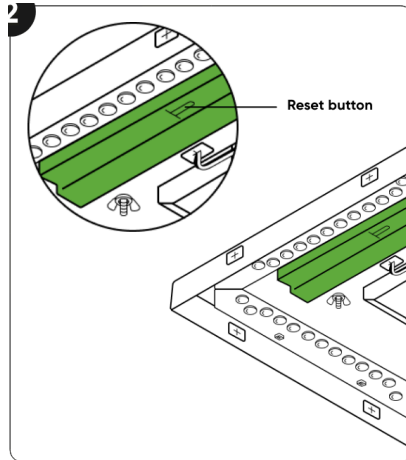

### Soft Reset

This will reset the Wi-Fi and all saved pairing configurations. Your saved scenes will remain.

1. Press the reset button on the Main Controller Panel for **5 seconds**
2. Your Skylight Panels will restart on low brightness. Once the boot up process is complete, the panels will gradually shift to full brightness to indicate that the system is ready for pairing.
3. On the Nanoleaf App, delete the previous device and re-pair it again.

### Hard Reset

This is a factory reset that will reset the Wi-Fi, saved pairing configurations, and all saved scenes.

1. Press the reset button on the Main Controller Panel for **10 seconds**
2. Your Skylight Panels will restart on low brightness. Once the boot up process is complete, the panels will gradually shift to full brightness to indicate that the system is ready for pairing.
3. On the Nanoleaf App, delete the previous device and re-pair it again.

## Common Solutions

### “I moved or changed my Wi-Fi network.”

Try the Reset Option in the section above before attempting to pair again. Press the reset button on the Main Controller Panel. After this, attempt pairing again.

### “My Skylight is paired but unreachable.”

#### **Check a light switch**

Before resetting, make sure that your lights weren't turned off by a physical switch as this would make them powered down and unresponsive. Try turning your physical (manual) switch on and off.

#### **Try to Toggle your Wi-Fi**

On your phone, toggle the Wi-Fi off, then on again.

#### **Try to Power Cycle your Router**

Unplug your Router from power, then plug it back in.

#### **Try to Reset**

See **Reset Options** for details on how to reset your Skylight.

### “I am not able to pair my Skylight.”

#### **Check your Router Settings**

On your phone, toggle the Wi-Fi off, then on again.

Ensure multicast, IGMP, UPnP (if available) are enabled on your router settings.

#### **Try to Reset**

See **Reset Options** for details on how to reset your Skylight.

## FAQs

**Q: Can Nanoleaf Skylight be used with a dimmer switch?**

**A:** Skylight is not compatible with a traditional dimmer switch. Dimming your Skylight can be done via the Nanoleaf app or through a smart home ecosystem.

**Q: Does Skylight require hardwiring, or can it be plugged into an outlet?**

**A:** Skylight requires hardwiring- basic electrical experience is recommended for installation. Only the Main Controller Panel has to be hardwired - the other panels are connected to the controller using power and communication wires. The power wires are AC operated, so it is recommended to install your Skylight with the breaker turned off.

**Q: How many electrical contacts do I need to power my Nanoleaf Skylight?**

**A:** One. Even though you can have several (up to 100) Nanoleaf Skylight panels connected together, they all run on the same electrical contact. Only the main controller panel has to be hardwired.

**Q: How many panels can I connect?**

**A:** You can connect up to 100 panels on one controller using a single AC power source.

**Q: Why did Nanoleaf not use the Shapes Linker for this product?**

**A:** Due to specific fire and electrical safety standards for ceiling fixtures, we opted for two sets of wires instead of our Shapes Linker for Nanoleaf Skylight.

One of these wires is the **Power Wire**, which is used to connect & hardwire your Skylight into your space's electrical system. The other wire is the **Communication Linker**, which communicates with our Nanoleaf Layout Detect technology, and allows you to customize your lights through the Nanoleaf App.

**Q: What is the default power configuration for Nanoleaf Skylight?**

**A:** When you turn on your Skylight via a manual light switch, it will automatically default to a Warm White at 100% Brightness. This can be changed and customized through the Nanoleaf App.

**Q: Why is my Nanoleaf Skylight unreachable even when the product is lit up?**

**A:** When you switch your Skylight on via a manual light switch, it takes about 30 to 90 seconds for it to finish booting up. After this, your Skylight should be reachable via the Nanoleaf App.

If you are still having issues, please see our **Common Solutions** section for more support.